

# INCEELING TENSIONED PROJECTION SCREENS

ceiling recessed electric screens with side tensioning system

The screen is there ... but you see it only when you need it! In all environments where aesthetics is a primary need – both at home and in your office -, INCEELING TENSIONED represents the ideal solution. Thanks to its innovative concept, the electric rewinding screen is housed in the ceiling and, therefore, it is visible only when effectively used. The perfect flatness of the canvas is guaranteed by the side tensioning elastic cords: an exclusive technique that allows you to adjust the height in order to satisfy every need, Inceeling tensioned is extremely simple and economical both to be installed, as well as to be used.

## Technical Features

- **Screens** realised with the following projection fabric: SOFT WHITE, SOFT MATT WHITE, SOFT WHITE TRANSOUND, SOFT GREY, RETRO and MICRO TRANSOUND (see technical data sheet at pages 3-4-5)
- **Available** in the following formats: video 4:3 and HDTV 16:9, **with or without outer black borders of 5 cm and upper black drop** of variable height: the black edging increases the definition of the image projected on the screen
- **Screen lowering from the rear side of the box**, on demand it can be provided with front lowering system
- **Side tensioning system** by strong and high quality elastic cords that pass through the eyelets along the sides of the canvas, starting from the bottom, creating a side arm that preserves the fabric from the risk of folds in the rolling up phase despite the eyelets.
- **Extruded aluminium case, epoxy powder coated, in white** RAL 9010 colour, section mm 154x117, on the lower side a longitudinal slot with rounded edges allows the descend of the projection screen
- **Internal silver anodized aluminium tube for fabric wind up** Ø 61 mm or Ø 80 mm, which includes a reliable electric motor mounted on special rubber silent blocks.
- **Electric motor, single phase, IMQ, CE mark, 5-years guarantee** from purchasing date, power supply 200V-50Hz, absorption 0,5A, protection IP 44, 17 RPM., in the standard version the motor is mounted on the right hand side.
- **Screen up and down electric inverter, standard supplied**
- **Screen up and down limit switches factory adjusted**, possibility of different settings if necessary. The screen can also be stopped at intermediate height by pressing the electric inverter switch
- **Product standard Kit** consists of 8 threaded rods 50 cm for installation with maximum height of 1 m, terminals to close the plasterboard
- **The screen housing end caps** are in galvanized metal.
- **Counterweight** with nice design in white colour
- **Robust individual packing** in double cardboard type
- **Product CE certified**, 12 month warranty to the conditions indicated on the manual
- **Accessories on demand:** external radio remote control, integrated radio control

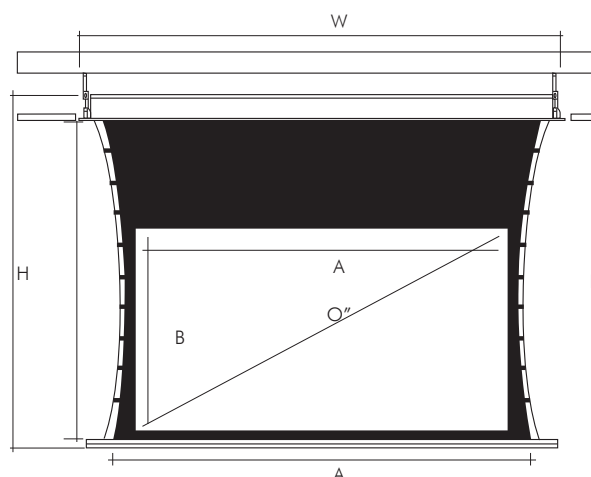
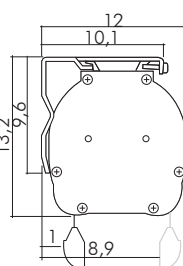
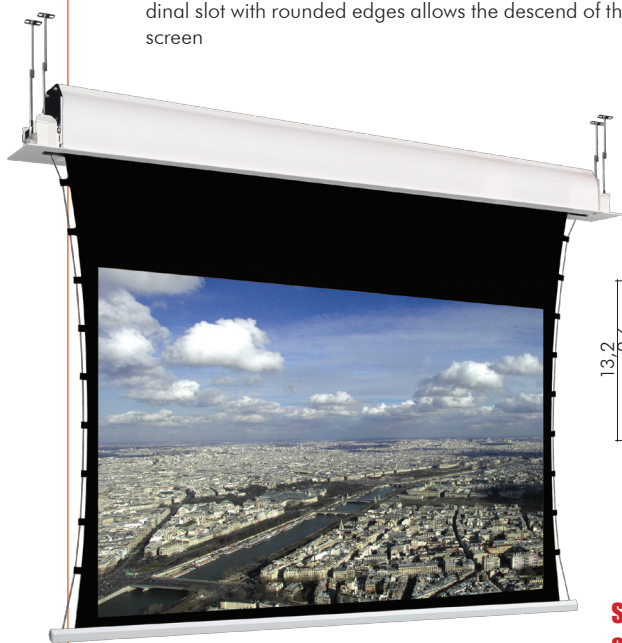

**SIZE, FORMAT, BORDERS & DROP TAILOR MADE ON DEMAND:**  
available with Soft White, Soft Matt White, Transound, Rear Projection fabric

Barcode	Model	Format	Aspect Ratio	Screen Width (cm)	Screen Height (cm)	Screen Diagonal (inches)	Motor Power (W)	Motor RPM	Motor Protection	Motor Voltage (V)	Motor Current (A)	Motor Weight (kg)	Motor Dimensions (cm)	Motor Weight (kg)	Motor Dimensions (cm)
	<b>692501 INCEELING TENSIONED 155x119</b>	4:3	155x119	145x109/71"	197x134	187x11,7	186,2x3,4	5	45	210x20x21	16	21			
	<b>692601 INCEELING TENSIONED 175x134</b>	4:3	175x134	165x124/81"	217x149	207x11,7	206,2x3,4	5	45	230x20x21	17	22			
	<b>692901 INCEELING TENSIONED 195x149</b>	4:3	195x149	185x139/91"	237x164	227x11,7	226,2x3,4	5	45	250x20x21	18	23			
	<b>693601 INCEELING TENSIONED 225x171</b>	4:3	225x171	215x161/106"	267x186	257x11,7	256,2x3,4	5	45	280x20x21	19	24			
	<b>694301 INCEELING TENSIONED 275x214</b>	4:3	275x214	265x199/130"	317x229	307x11,7	306,2x3,4	10	45	330x20x21	21	26			
	<b>697601 INCEELING TENSIONED 325x251</b>	4:3	325x251	315x236/155"	367x266	357x11,7	356,2x3,4	10	45	380x20x21	23	30			
	<b>692401 INCEELING TENSIONED 155x92</b>	16:9	155x92	145x82/65"	197x107	187x11,7	186,2x3,4	5	45	210x20x21	15	20			
	<b>692301 INCEELING TENSIONED 175x103</b>	16:9	175x103	165x93/75"	217x118	207x11,7	206,2x3,4	5	45	230x20x21	16	21			
	<b>693101 INCEELING TENSIONED 195x114</b>	16:9	195x114	185x104/84"	237x129	227x11,7	226,2x3,4	5	45	250x20x21	17	22			
	<b>693401 INCEELING TENSIONED 225x131</b>	16:9	225x131	215x121/97"	267x146	257x11,7	256,2x3,4	5	45	280x20x21	18	23			
	<b>693901 INCEELING TENSIONED 275x164</b>	16:9	275x164	265x149/120"	317x179	307x11,7	306,2x3,4	10	45	330x20x21	20	25			
	<b>694701 INCEELING TENSIONED 325x192</b>	16:9	325x192	315x177/142"	367x207	357x11,7	356,2x3,4	10	45	380x20x21	22	27			
	<b>698101 INCEELING TENSIONED 375x220</b>	16:9	375x220	365x205/165"	417x235	407x11,7	406,2x3,4	10	45	430x20x21	24	29			

Size, in cm, weights expressed in kilograms, diagonal expressed in inches (")