



TITAN

POLICHENELLE PROJECTION SCREENS

Screen base from 800cm to 1200cm

Screen	Type	Motorized
	Minimum size (A x B)	800x340 cm
	Maximum size (A x B)	1200x675 cm
	Max canvas width (A)	1200 cm
	Available Ratios	1:1, 4:3, 16:9, 16:10, 21:9
	Available canvas	Soft white, Soft Matt White, Transound, Retro
	Adjustments	Electronic, factory setting only
Case	Material	Steel and Aluminium
	Installation	Ceiling
	Extra width of the case (W)*	35 cm
	Standard colour	Grey, White, Black
Motor	Position	Center
	Type	Flanged with reducer
	Supply	370 W
	Tension	230 V
	Frequency	50 Hz
	Nominal supply	3,01 A
	Driving torque	2,48 Nm
	Protection	IP55
	Isolation	Class F
	Speed	7m/min
	Command	Electric command panel
Warranty and certifications	Screen warranty	24 months
	Motor warranty	24 months
	Certifications	CE, IMQ (motor), fireproof (canvas)
Differentiators	Highlights	<ul style="list-style-type: none"> The polichenelle system guarantees the perfect canvas planarity, making the TITAN screens an ideal solution for cinemas, theatres and auditoriums, allowing a fast change between projections and theatrical shows. Central motor with steel cables for a steady rolling and unrolling of the canvas Steel case covered with aluminium plates Top quality manufacturing and materials Side security system to prevent any accidental fall
	Why you should choose it	<ul style="list-style-type: none"> Aluminium-clad case Three standard colors available: Grey, White, Black The upper fixing system allows little adjustments of the canvas The electric command panel is ground-based and it's easily operated - it doesn't take ladders or scaffoldings to reach it Ceiling brackets and eyebolts provided with the screen 100% customizable Manufactured with Italian or EU materials Top-level safety systems
Accessories	Included	Electric control panel, safety belts, ceiling brackets, eyebolts, manual
	Not included	Truss brackets, wall brackets

* Extra width of the case compared to the projection screen

Top view

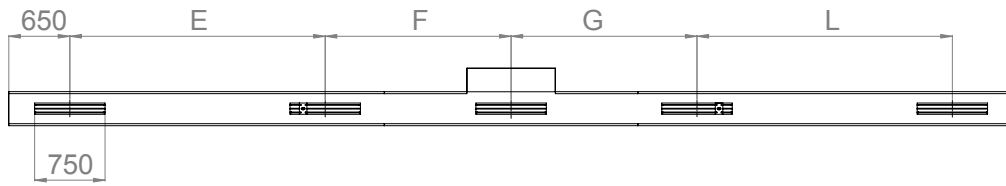

Front view

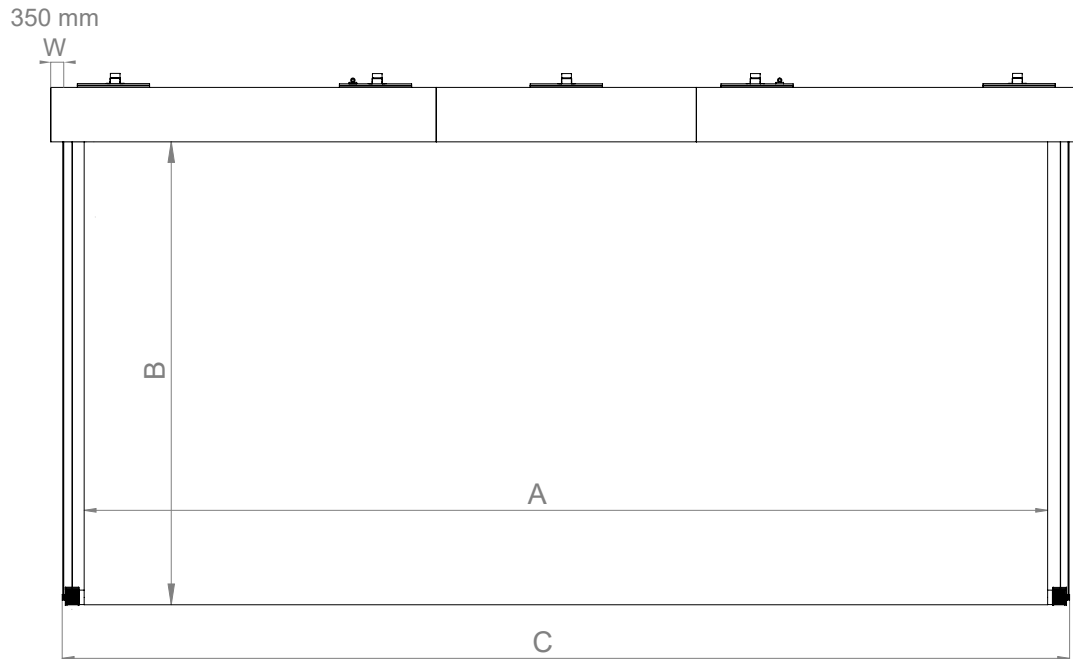

Side view with ceiling mounting system with optional spacers

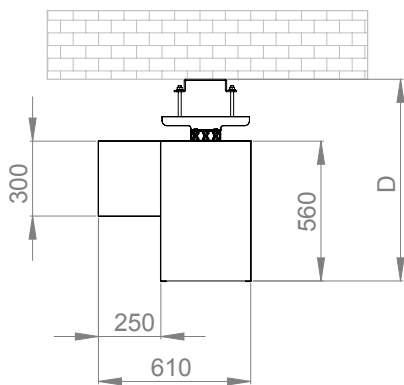

Side view with ceiling mounting system

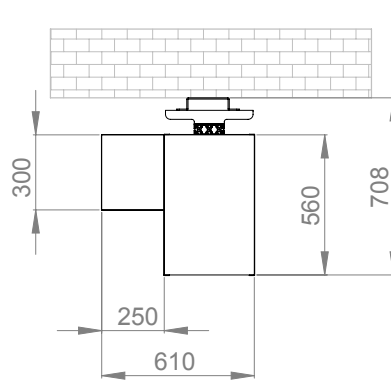

Side view with truss mounting system

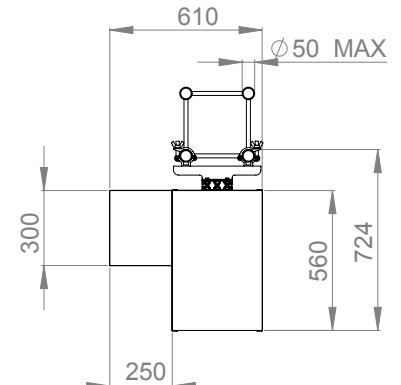

Ceiling suspension bracket

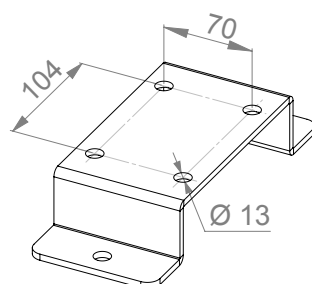

Truss suspension bracket

